



# NIAGARA

Building & finishing products

## Exterior timber building products



Produced entirely from quality New Zealand radiata pine, Niagara's dressed boards, fascia, weatherboards and laminated posts are ideal for exterior building projects including verandahs, porches, patios and percolas.



[www.niagara.net.nz](http://www.niagara.net.nz)

Niagara's building products are kiln dried to between 10-14% moisture content then finger jointed and/or laminated, using glues that ensure the finished product **meets NZ standards** - producing a clear, defect-free straight board, post or moulding.

You can rely on the new generation preservation system based on safe, organic and biodegradable active constituents to provide full **25 year protection** from insects and decay.

For a superior finish Niagara's products are pre-primed on all faces under quality controlled conditions with an alkyd true primer which has been specially developed by Resene Paints Ltd. This revolutionary primer has **greater weather and UV resistance** and gives a genuine base ready for topcoating with either an alkyd or waterborne paint.



## Finger jointed dressed boards

Finger jointed, treated to H3.1 and factory primed Length 5.4, 6.0

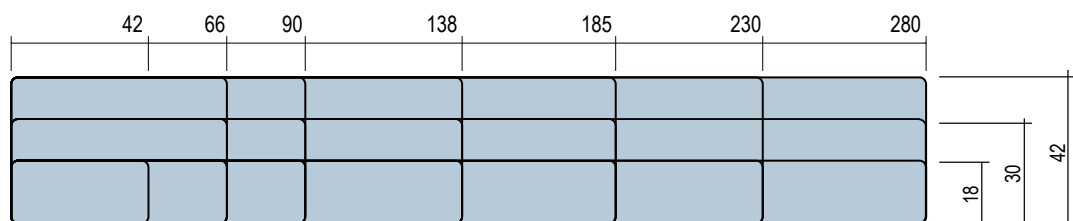

## Solid dressed boards

Available in clears or dressing grade, treated to H3.1, or untreated unprimed Random Lengths

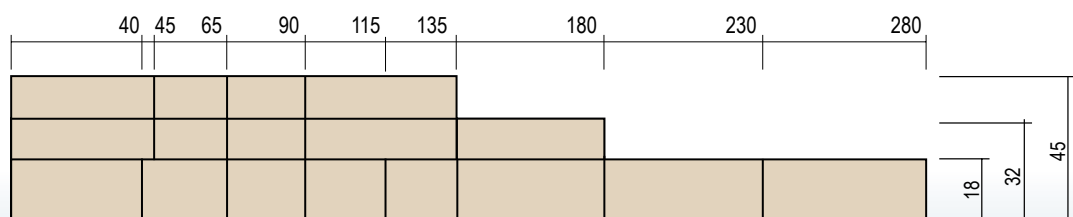

*Timber grades are illustrated on reverse*

**Ask for Niagara's products at timber merchants throughout New Zealand**

For technical information & installation guidelines visit: [www.niagara.net.nz](http://www.niagara.net.nz)

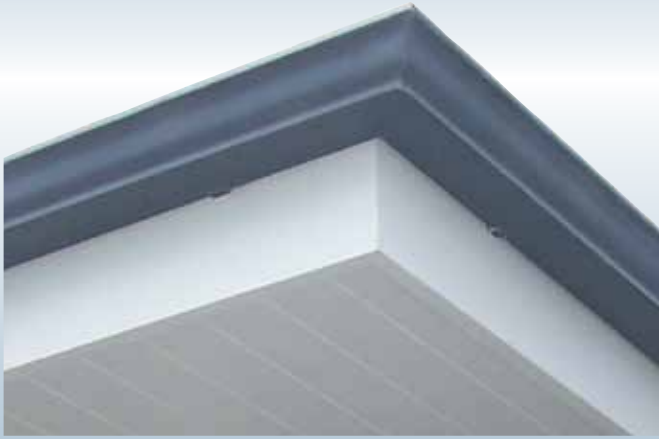

Laminated timber is structurally consistent, more stable and less likely to twist or warp, making it ideal for structural verandah posts.



## Fascia

Finger jointed, treated to H3.1 and factory primed.

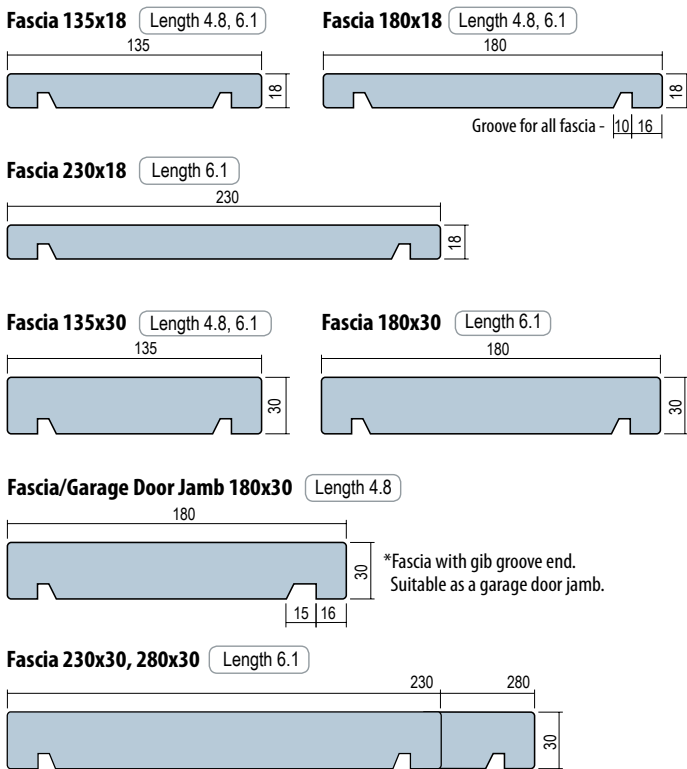

## Verandah posts

Finger jointed, laminated, treated to H3.1 and factory primed.

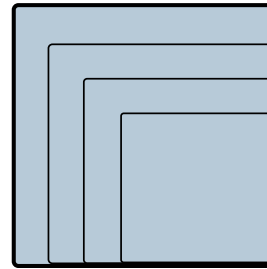

### Post 88x88

Length 2.4, 2.7, 3.0, 3.6, 4.8, 5.4, 6.0

### Post 112x112

Length 2.4, 2.7, 3.0, 3.6\*

### Post 135x135

Length 2.4, 2.7, 3.0, 3.6\*

### Post 185x185

Length 2.4, 2.7, 3.0, 3.6, 4.8, 5.4, 6.0

\*Longer lengths available on request



## Battens

Finger jointed, treated to H3.1, unprimed

### Ceiling Battens

Length 5.4

### Cavity Batten

Length 5.4

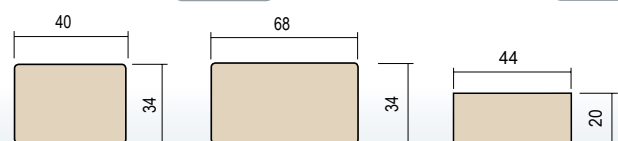

# ENVIRA

Timber Cladding  
weatherboard system

This full component system includes all that's needed to make the job fast and ensure a weather-tight finish is achieved.

Use the **pre-cut scribes** as a simple spacing guide and finish your corners with **smart box corners**.

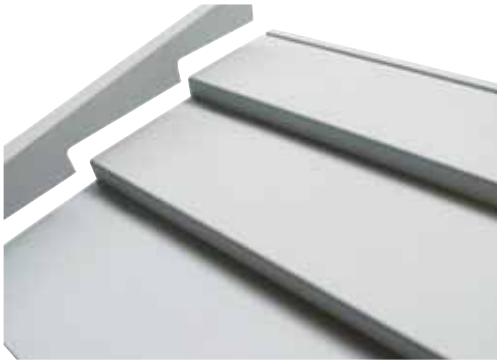

Installing a timber bevel back scribe - above



Installing a timber box corner and rusticated scribe - above

**Choose from rusticated, bevel back or shiplap styles.**

All weatherboards and components are treated to H3.1 and factory primed on four faces and is available in three timber grades (illustrated below) Ask for Envira Timber Cladding at your local timber merchant.

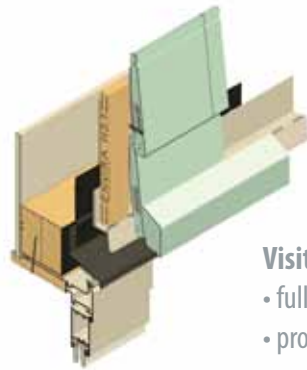

Complete your weatherboard building with Envira box corners (above) or aluminum etched corner soakers



**Visit our website for:**

- full detailed drawings
- product specifications
- current photo gallery
- installation techniques
- warranty information
- care and handling details

## Niagara timber grades

**Dressing Grade:** A high grade board with sound tight knots and other natural characteristics.



**Finger Jointed:** Clear boards with glued, finger joints throughout. Defect-free, smooth finish.



**Solid Clears:** Clear on all four sides apart from minor imperfections.



Niagara products carry the internationally-prized FSC® (Forest Stewardship Council®) certification. Ask your timber merchant for Niagara's FSC timber when you purchase.



[www.niagara.net.nz](http://www.niagara.net.nz)



### Storage

All Niagara products must be stored in a dry well-ventilated area, stacked on a flat surface at least 150mm above the ground, covered and out of direct sunlight or rain.

PHONE 0800 FOR TIMBER (0800 36 78 46) or 03 308 0007